

KUM Series (KLT, U-shape coreless, Medium size)

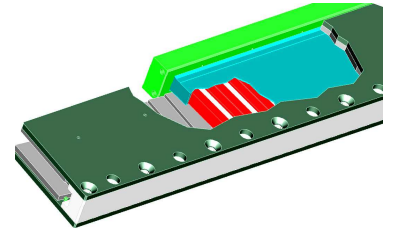

Motor Specifications

Items		Model	KUM-2S	KUM-3S	KUM-4S	KUM-5S
Force [N]	Continuous		172.8	259.2	345.6	432.0
	Peak		518.8	778.2	1,037.6	1,297.0
Current [A_{rms}]	Continuous		4.6	4.6	4.6	4.6
	Peak		13.8	13.8	13.8	13.8
Back EMF Const [$V_{rms}/(m/s)$]			12.5	18.8	25.0	31.3
Motor Constant [N/A_{rms}] <small>note1)</small>			37.57	56.35	75.13	93.91
Max. Velocity [m/s] <small>note2)</small>			6.43	3.61	2.20	1.35
Resistance [Ω] <small>note1)</small>			1.5	2.3	3.0	3.8
Inductance [mH] <small>note1)</small>			1.4	2.1	2.8	3.5
Attraction Force [N] <small>note3)</small>			0	0	0	0
Mover Weight [kg]			1.8	2.0	2.7	3.2

Note1) All Parameters indicate at phase level (3-phases, Y-connection, Phase-to-Neutral) at room temperature.

Note2) Motor Driver works for 3 phases with AC 200V~320V and maximum velocity is subjected to modified by DC link voltage.

Note3) Magnetic attraction force is between the coils and the magnets through air-gap.

Force-Velocity Characteristics

Rated Area

Peak Area

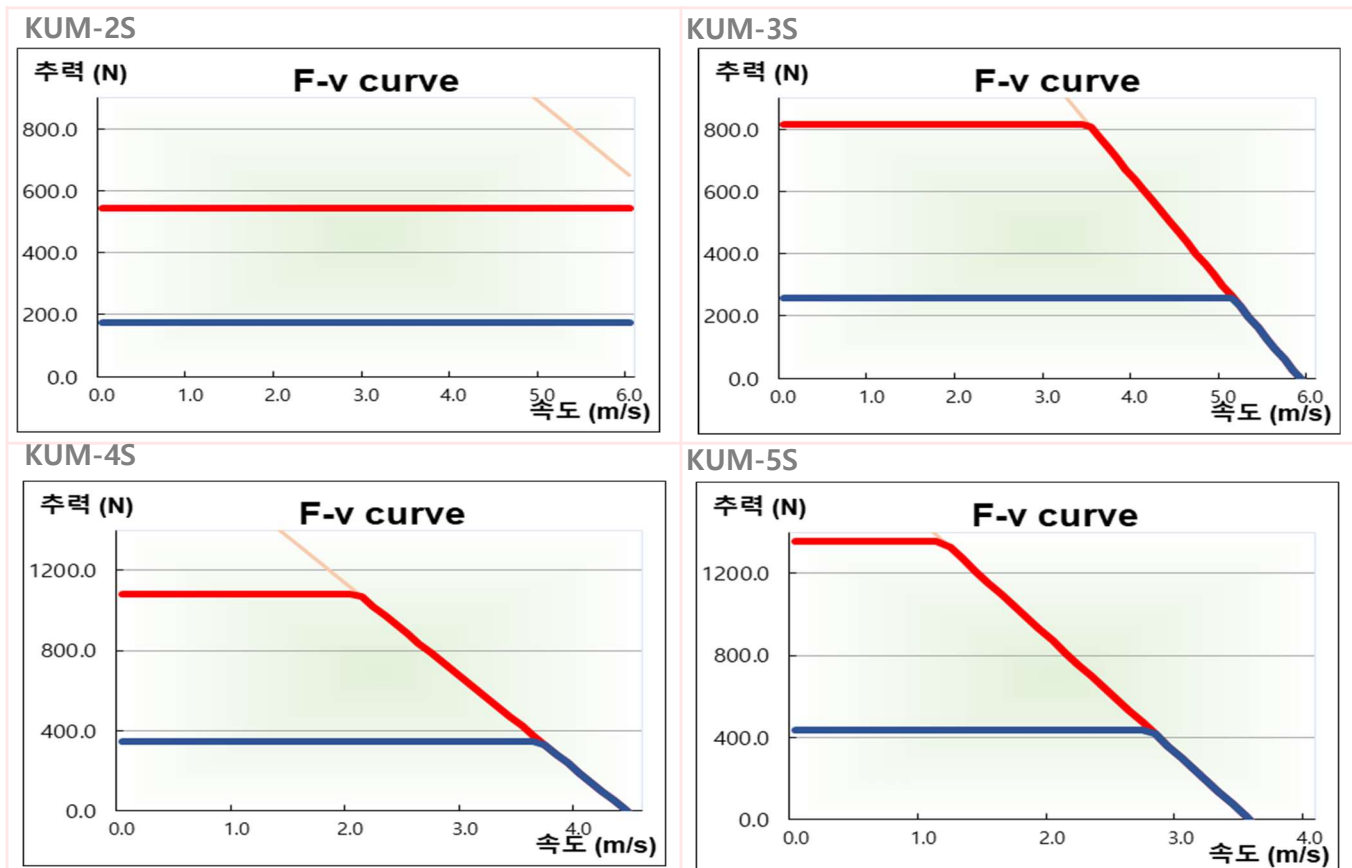

Outline Dimension

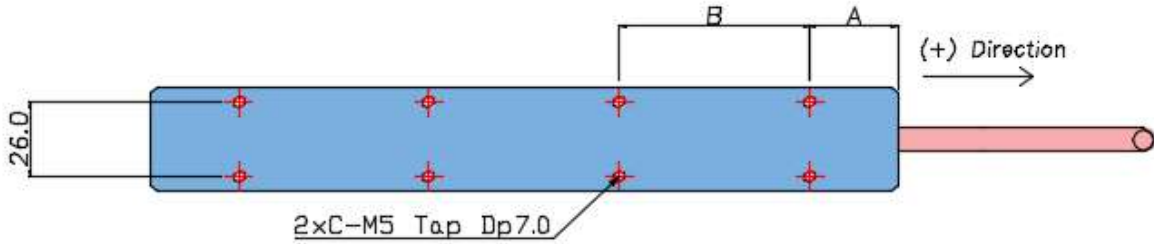

Model	A [mm]	B [mm]	C(Q'ty)	D [mm]	L1 [mm]
KUM-2S	31.0	67.5	3	108.5	125.8
KUM-3S	31.0	67.5	4	264.5	281.8
KUM-4S	31.0	67.5	5	342.5	359.8
KUM-5S	31.0	67.5	6	420.5	437.8

• KUM-1P Models is available for special purpose.

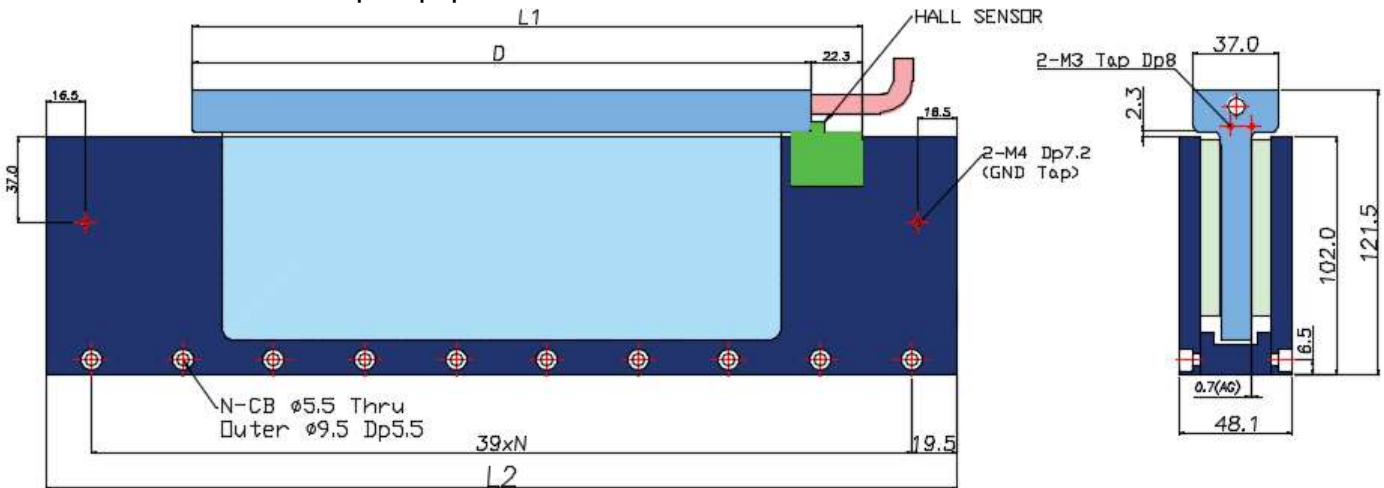

Model	L2 [mm]	N(Q'ty)	Weight [kg]	Pole Pitch
KUM-156	156.0	4	4.0	19.5mm
KUM-390	390.0	10	9.8	
KUM-507	507.0	13	12.9	

Motor and Hall sensor Cables

Cables	Signals	Colors	Length
Motor Cable (AWG18)	U	Red	STD: 0.6M OPTION: 1.0M, 1.5M, 2.0M, ETC
	V	Blue	
	W	Yellow	
	FG	Green	
Hall Sensor Cable (AWG22)	+5V	Red	STD: 0.6M OPTION: 1.0M, 1.5M
	GND	Black	
	H1 (U)	Blue	
	H2 (V)	Green	
	H3 (W)	White	

• The Hall offset angle in each phase is 60 degree at falling edge.

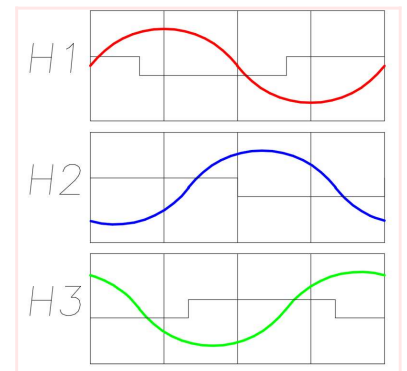

* Hall Sensor phase at Back EMF.