

KUXE Series (KLT, U-shape coreless, X-large size) (Economic Type)

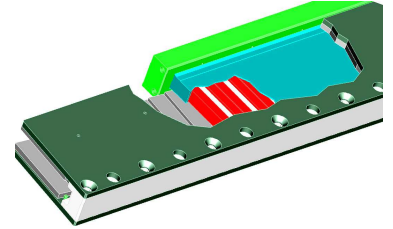

Motor Specifications

Model		KUXE-2P	KUXE-3P	KUXE-4P
Force [N]	Continuous	678.0	1,017.0	1,356.0
	Peak	2,162.0	3,243.0	4,324.0
Current [A _{rms}]	Continuous	6.9	10.3	13.8
	Peak	22.0	33.0	44.0
Back EMF Const[V _{rms} /(m/s)]		32.85	32.85	32.85
Motor Constant[N/A _{rms}] note1)		98.55	98.55	98.55
Max. Velocity[m/s] note2)		1.8	1.8	1.8
Resistance [Ω] note1)		1.7	1.2	0.9
Inductance [mH] note1)		9.2	6.2	4.6
Attraction Force[N] note3)		0	0	0
Mover Weight [kg]		6.5	9.3	12.7

Note1) All Parameters indicate at phase level (3-phases, Y-connection, Phase-to-Neutral) at room temperature.

Note2) Motor Driver works for 3 phases with AC 200V~320V and maximum velocity is subjected to modified by DC link voltage.

Note3) Magnetic attraction force is between the coils and the magnets through air-gap.

Force-Velocity Characteristics

Rated Area

Peak Area

KUXE-2P

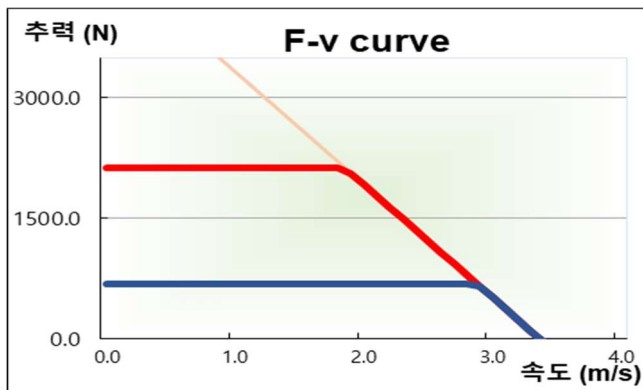

KUXE-3P

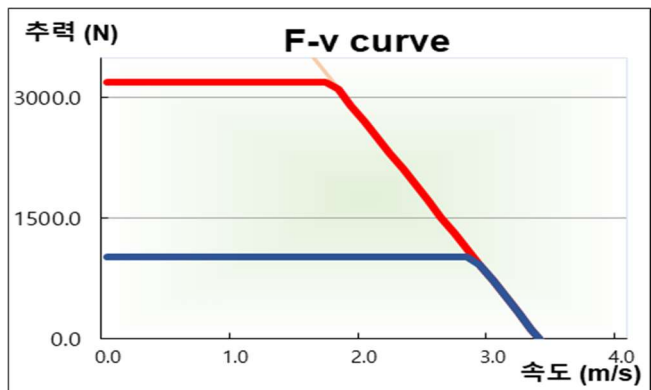

KUXE-4P

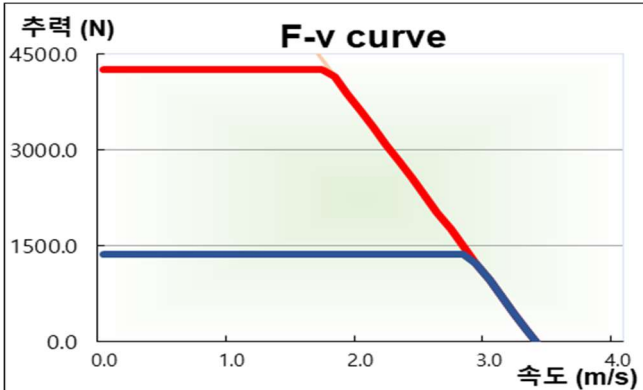

Outline Dimension

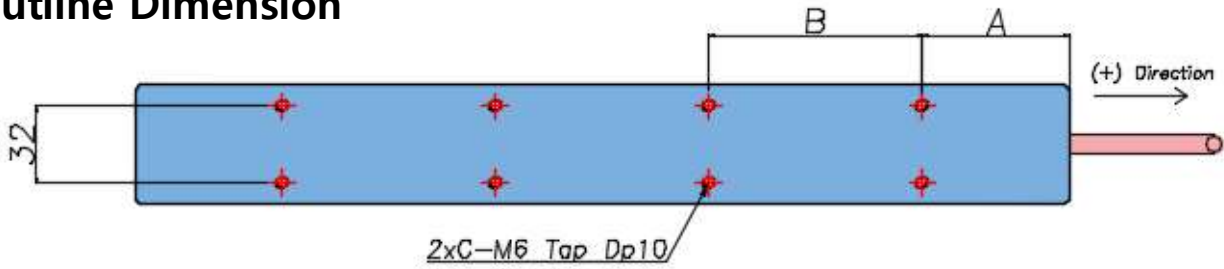

Model	A [mm]	B [mm]	C(Q'ty)	D [mm]	L1 [mm]
KUXE-2P	62.0	90.0	4	394.0	429.0
KUXE-3P	62.0	90.0	6	574.0	609.0
KUXE-4P	62.0	90.0	8	754.0	789.0

•KUXE-1S & KUXE-2S2P Models are available for special purpose.

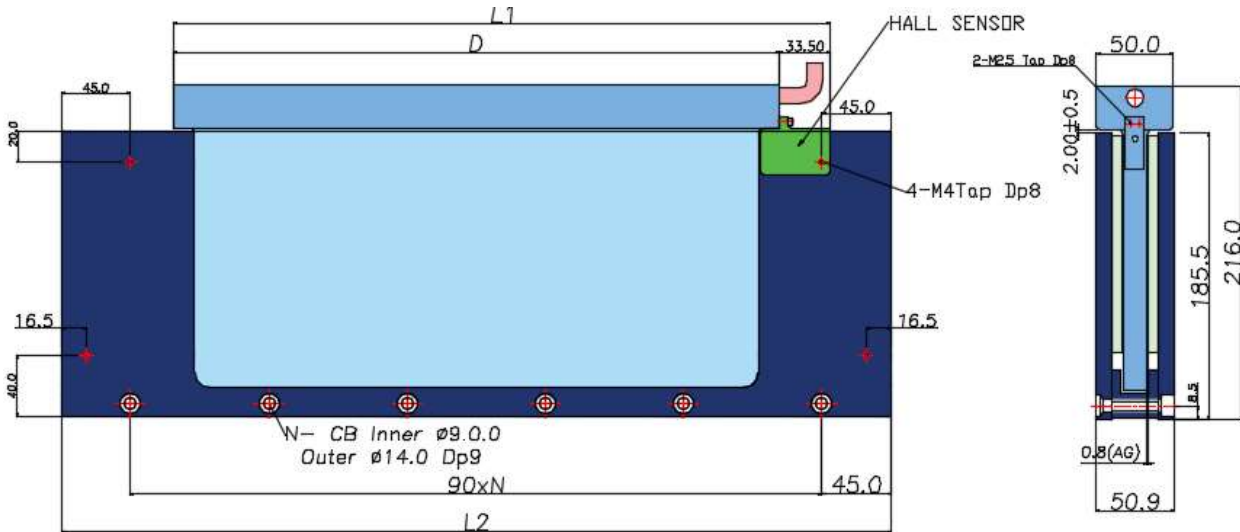

Model	L2 [mm]	N(Q'ty)	Weight [kg]	Pole Pitch
KUXE-180	180.0	2	2.2	45.0mm
KUXE-270	270.0	3	13.3	
KUXE-360	360.0	4	16.2	

- Pole Pitch is (N-S or S-N) magnet distance with 180 degrees.
- Other model with specific length can be supplied for specific order.

Motor and Hall sensor Cables

Cables	Signals	Colors	Length
Motor Cable (AWG14)	U	Brown	STD: 0.6M OPTION: 1.0M, 1.5M, 2.0M, ETC
	V	Black	
	W	Blue	
	FG	Green	
Hall Sensor Cable (AWG22)	+5V	Red	STD: 0.6M OPTION: 1.0M, 1.5M
	GND	Black	
	H1 (U)	Blue	
	H2 (V)	Green	
	H3 (W)	White	

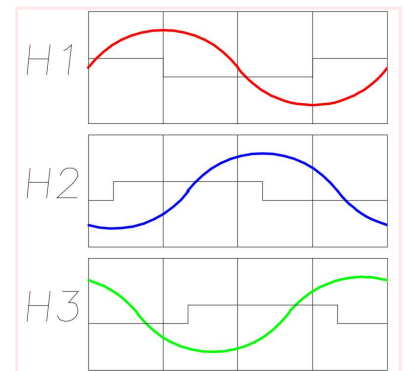

• The Hall offset angle in each phase is 90 degree at falling edge.

* Hall Sensor phase at Back EMF.