

# KV Series (KLT, Voice-Coil motor)

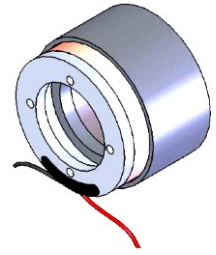

All VCM's can be modified from Standard models to fit for Customer's requirements.

## Standard Model

Part Number	Peak Force	Const. Force	Stroke	Max. Voltage	B.EMF	Outer Diameter	Height (Mid.)
	(N)	at 25°C(N)	(mm)	(V)	(V/m/s)	(mm)	(mm)
KVEC0001-001-00A	0.7	0.35	1	1.7	0.21	25	11.6
KVEC0005-005-000	5	2.5	5	12.5	3.6	25	18.2
KVEC0008-0005-000-HW	8.3	4.3	5	17.6	10.4	27	32.1
KVEC0010-010-00A	10	6.5	10	7.3	5.2	32	35.2
KVEC0015-005-000	15	6.5	5	26	9.8	35	24.6
KVEC0015-0015-000	15	4.1	15	13.9	4.9	35	37.3
KVEC0018-006-000	18	5.6	6	18.0	5.6	20	37.5
KVEC0030-005-000	30	9.0	5	28	7.1	40	41.6
KVEC0030-010-000	30	8.0	10	22	5.9	35	26.7
KVEC0035-010-000	35	15.6	10	11.9	5.0	50	72.0
KVEC0040-005-00A	40	13.4	5	17.2	8.6	39.3	28.9
KVEC0045-025-000	45	11.8	25	45	9	40	63.8
KVEC0046-015-000	46.2	11.3	15	17	18.5	38	64.9
KVEC0050-025-000	50	15	25	20.8	6	38.2	57.5
KVEC0050-035-000	50	16.7	35	22.5	8.9	38.4	76.0
KVEC0060-015-000	60	26	15	23	17.7	45	61.2
KVEC0070-015-000	70	27.5	15	27	17.7	45	61.2
KVEC0075-020-000	75	30	20	26.2	15.2	70	48.7
KVEC0080-005-000	80	21.8	5	31.5	12.7	40	38.4
KVEC0090-010-00A	90	31.5	10	30	20.1	45	60.0
KVEC0100-005-000-HW	100	28.1	5	17.0	11.2	50	50
KVEC0100-015-000	100	35.5	15	19.2	11.5	60	63.5
KVEC0137-010-000	137	33.7	10	21.1	27.4	60	79.0
KVEC0176-010-000	176	47.9	10	52.5	36.9	45	88.2
KVEC0230-035-000-HW	230	70.7	10	80.3	35.1	120	95
KVEC0250-010-000	250	110	10	34	41.2	75	70.6
KVEC0250-025-000	250	115	25	27	26	70	125.5
KVEC0300-050-000	300	56	50	116	24.5	93	161.9
KVEC0400-025-000	400	170	25	28.5	38	80	122.5
KVEC0950-025-000	950	607	25	40	105	130	137.9
KVEC1300-030-000	1300	385	30	69	70	110	160.0

[Note] HW(Hollow) type is available.